

T&B DUAL

EXPANDABLE TO 2-DOG SYSTEM

Owner's Manual

Please read this manual thoroughly
before operating the T&B DUAL
Training & Beeper Collar.

IMPORTANT SAFETY AND PRODUCT INFORMATION

WARNING

Please read all safety and product information below before using your Dogtra product. Failure to follow these safety instructions could result in injury to you, your dog and others, or it could result in damage to your Dogtra product or other property.

PRODUCT SAFETY

Training Methods

Dogtra products may be used with a variety of training methods. However, each dog may have a different reaction to training methods and to Dogtra products. Closely observe your dog when determining the right training method to use with your Dogtra product.

Aggressive Dogs

Do not use Dogtra products with aggressive dogs as such dogs may react adversely and cause injury to people or other dogs. Seek the assistance of a dog-training specialist or veterinarian when dealing with aggressive dogs.

Children

Dogtra products are not toys. Adult supervision and close attention are necessary when Dogtra products are used by or near children.

PRODUCT DAMAGE

Electrical Product

Your Dogtra product contains electrical components and batteries. Do not use or keep your product near heat or flammable sources. Such use or storage may damage your product and/or cause fire, explosion, injury, or property damage.

Medical Device Interference

Dogtra products contain electrical and magnetic components that emit low level electromagnetic waves and radio frequencies. These electromagnetic waves or radio frequencies may interfere with pacemakers, defibrillators, or other medical devices. Consult your physician or medical device maker before using your medical device with a Dogtra product. If you think that your Dogtra product is interfering with your pacemaker, defibrillator, or other medical device, stop using the Dogtra product.

Inadvertent Activation

The digital microprocessor offers thousands of unique codes to eliminate frequency match-up with other Dogtra e-collars. The Constant button will automatically shut down after being held down for 12 seconds or more as a safety feature.

UNAUTHORIZED USE

Your Dogtra product should be used only in a humane manner to train and educate your dog. Dogtra products are not intended for use in any other manner nor are they intended for use with other animals or with humans.

BATTERY

Your Dogtra product contains batteries. Take care when removing and installing batteries as your fingers may get caught. Dispose of batteries as provided by your local regulations. Do not disassemble, crush, heat, or otherwise alter the battery as it may cause fire, injury or property damage.

CONTENTS

AT A GLANCE	5
MAIN FEATURES	6
OVERVIEW	7
UNDERSTANDING YOUR TRAINING SYSTEM	
1. TURNING THE T&B DUAL ON/OFF	10
2. TRANSMITTER BUTTON FUNCTION	12
1) BEEPER SETTING	12
2) TRAINING SETTING	17
3. COLLAR FITTING	20
4. FINDING THE RIGHT STIMULATION	21
5. MAXIMIZING THE DISTANCE	22
6. LED INDICATOR	23
7. CHARGING THE BATTERY	24
8. HANDHELD TRANSMITTER OLED	27
9. ATTACHING THE BELT CLIP	29
10. USING THE TEST LIGHT	30
11. CODE SETTING GUIDE	33
GENERAL TRAINING TIPS	35
MAINTENANCE	37
TROUBLESHOOTING GUIDE	38
WARRANTY AND REPAIR INFORMATION	41

AT A GLANCE

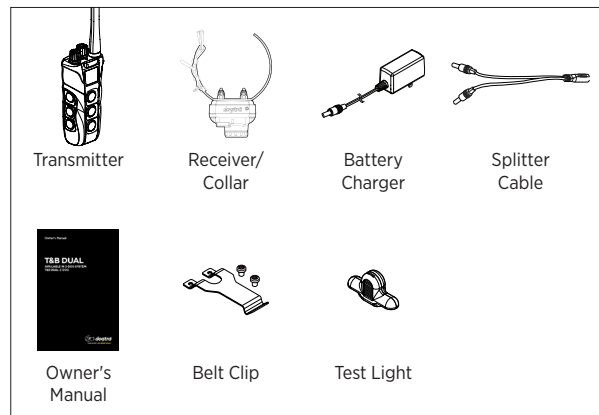

Optional Accessories

Auto Charger

Dogtra's auto chargers are designed for use with a 10 volt car outlet.

European Charger

Dogtra's European chargers are designed for use with a 230 volt AC electrical outlet.

To purchase accessories, please visit www.dogtra.com or call customer service at 1-888-811-9111.

MAIN FEATURES

- Rheostat Dial for gradual adjustments in stimulation intensity with no jumps between levels (0-127)
- Two-dog model allows control of two different dogs from one transmitter
- 1.5-mile range
- Two different stimulation types - Nick & Constant
- High Performance Pager (HPP) vibration
- Advanced Accelerometer run/point sensor
- Three beeper modes - Run/Point, Point-Only, and Locate
- Two different beeper pitches - low & high pitches
- Combines the receiver with the beeper horn into one small, compact unit
- 2-hour rapid charge lithium polymer batteries
- Fully waterproof receiver/collar and transmitter
- No bothersome external antenna on the receiver/collar
- Easily visible OLED screen displays each dog
- Three bar battery life indicator and LED colored indicator to show battery life

OVERVIEW

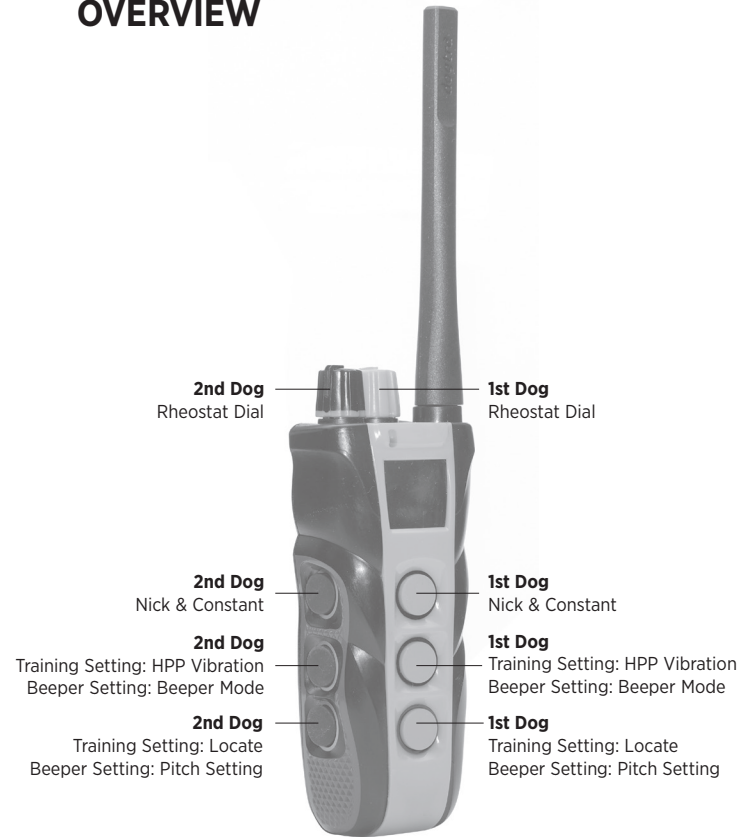

**T&B DUAL
Transmitter**

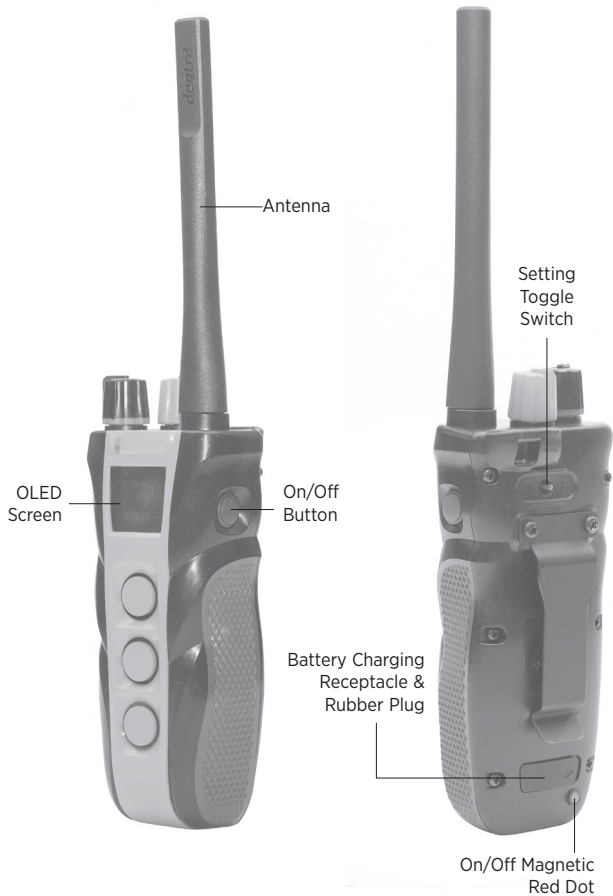

**T&B DUAL
Transmitter**

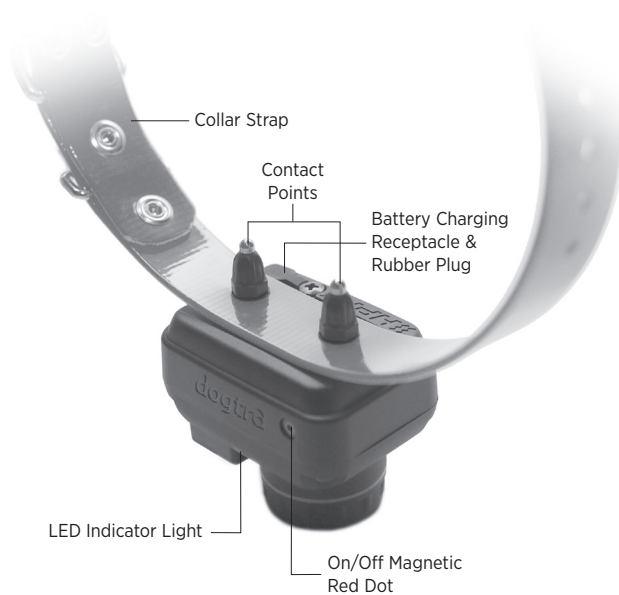

**T&B DUAL
Receiver/Collar**

UNDERSTANDING YOUR TRAINING SYSTEM

1. Turning the T&B DUAL On/Off

To turn the handheld transmitter on, hold down the button on the right side of the transmitter until the OLED screen illuminates. To turn the transmitter off, hold down the same button on the right side of the transmitter until the OLED screen shuts off.



Receiver On/Off Magnetic Red Dot

To turn on the receiver/collar, place the magnetic red dot on the back of the transmitter to the red dot on the receiver/collar. Hold the two red dots together for a moment until the LED light on the receiver/collar comes on. The receiver/collar will emit a melody when turned on.

To turn off the unit, repeat the same procedure holding the two red dots together momentarily. The LED light will turn red for a brief moment indicating that the receiver/collar has now shut off. The receiver/collar will emit a melody when turned off.

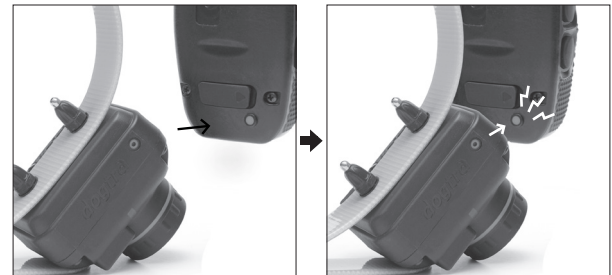

2. Transmitter Button Function

1) Beeper Setting



The transmitter for the T&B DUAL has seven buttons (three on the face of the transmitter, three on the left side, and one on the right). You can use the Setting Toggle Switch on the back of the transmitter to change from **T** (Training Setting) to **B** (Beeper

Setting). The Beeper Setting offers Nick/Constant, Beeper Mode, and Pitch Setting functions.

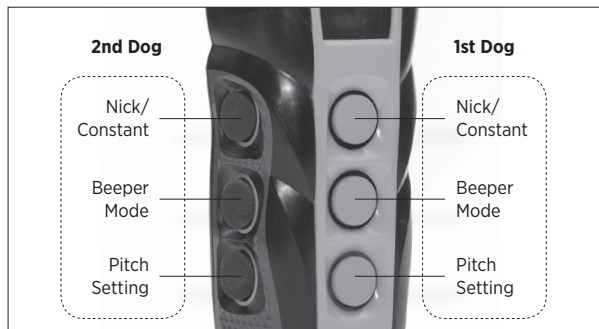

Nick/Constant Button

There are three buttons each on the front and left side of the transmitter. The Nick/Constant button is the top button on each side of the transmitter. When the button is pressed quickly, the Nick function is activated and the receiver emits a single rapid pulse of electrical stimulation. When the button is pressed more than two seconds, the Constant function is activated and the receiver emits a continuous stimulation as long as the button is pressed, for up to 12 seconds. If the button is not released after 12 seconds, the stimulation will automatically turn off as a safety feature. The collar will be ready to be reactivated once the button has been released.

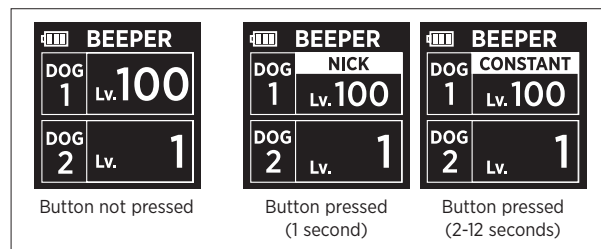

Beeper Mode Button (Run/Point & Point-Only)

The middle button is the Beeper Mode button for each side of the transmitter. When you press the Beeper Mode button the first time, the collar will beep twice. The beeper unit will always start in Run/Point mode. The beeper will sound every 7 seconds while the dog is running, and every 2 seconds when the dog is on point or becomes stationary. The second time you push the Beeper Mode button, it will beep once and remain silent while the dog is running and beep every 2 seconds when the dog is on point or stationary.

To turn the beeper unit off, press the Beeper Mode button a third time. The unit will emit three rapid beeps, and the beeper will turn off. The Locate mode can still be used!

	Initial Beeper Sound	Mode	Action
Press 1st Time	2 Beeps	Run/Point Mode	- Dog running/moving: emits double beep every 7 seconds - Dog stationary/pointing: emits double beep every 2 seconds
Press 2nd Time	1 Beep	Point-Only Mode	- Dog running/moving: silent - Dog stationary/pointing: emits double beep every 2 seconds
Press 3rd Time	3 Beeps	No Beeper Mode	No sound

Note: Even if the Beeper Mode is being used, you can still use the Locate function by changing the Toggle Switch to Training Setting.

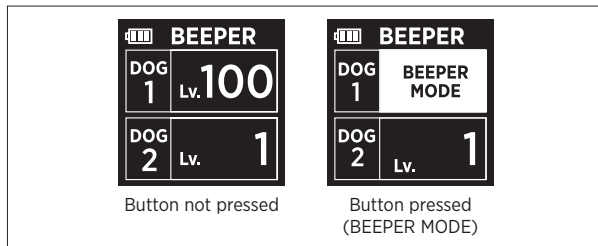

Pitch Setting Button

You can change the pitch of the beeper by pressing the Pitch Setting button, the bottom button on each side of the transmitter. The speaker with one bar will be the low pitch, while the speaker with three bars will be the high pitch. See the figure below.

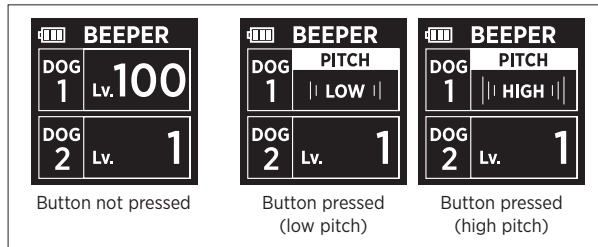

When the Pitch Setting is set on low pitch, the beeper will emit a double beep when it is in Run/Point mode or Point-Only mode. If the Pitch Setting is set on high pitch, the beeper will emit a single beep when it is in Run/Point or Point-Only mode.

2) Training Setting



You can use the Setting Toggle Switch on the back of the transmitter to change from **B** (Beeper Setting) to **T** (Training Setting). The Training Setting offers Nick/Constant, HPP Vibration, and Locate functions.

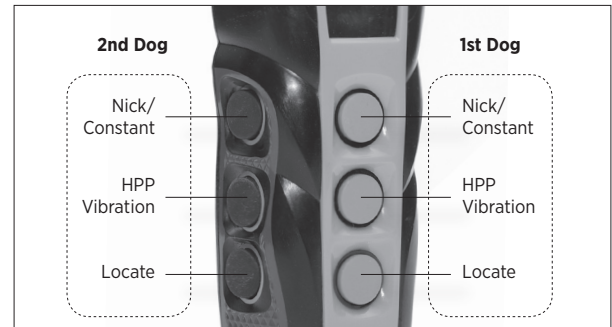

Nick/Constant Button

There are three buttons each on the front and the left side of the transmitter. The Nick/Constant button is the top button on each side. When the button is pressed quickly, the Nick function is activated and the receiver emits a single rapid pulse of electrical stimulation.

When the button is pressed more than two seconds, the Constant function is activated and the receiver emits a continuous stimulation as long as the button is pressed, for up to 12 seconds. If the button is not released after 12 seconds, the stimulation will automatically turn off as a safety feature. The collar will be ready to be reactivated once the button has been released.

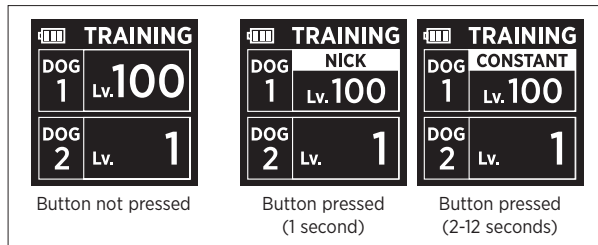

HPP Vibration Button

The middle button is the HPP Vibration button for each side of the transmitter. Pressing it will give a vibration for as long as the button is pressed, for up to 12 seconds.

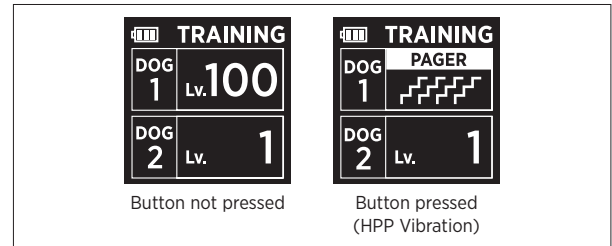

Locate

The Locate button is the bottom button on each side of the transmitter. The Locate button causes the collar's beeper horn to emit a series of beeps when held down and gives you the ability to keep track of your dog's location. The pitches of both the 1st and 2nd dog can be adjusted in the Beeper Setting.

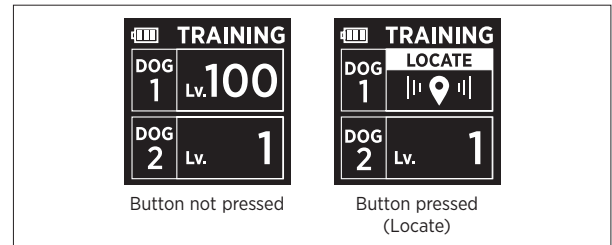

3. Collar Fitting

Proper Fit

The collar should be fitted so that the surgical stainless steel contact points press firmly against the dog's skin. You should be able to fit a finger in between the contact point and your dog's skin. The best location is on either side of the dog's windpipe.

Improper Fit

A loose fit can allow the collar to move around on the dog's neck. When this happens, the contact points may rub against the skin and cause irritation. If the collar is too loose, the contact will not be consistent and cause the corrections to be inconsistent. Dogtra uses surgical stainless steel contact points and anti-microbial plastic to protect the dog's skin.

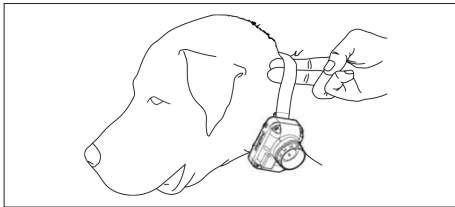

Attention!

Leaving the receiver/collar in the same location on the dog's neck for an extended period of time can cause skin irritation. If the dog is to wear the e-collar for long periods, occasionally reposition the collar so that the contact points are moved to a different location on the dog's neck. Make sure you check for skin irritation each time you use the unit.

4. Finding the Right Stimulation

Intensity Selection

The T&B DUAL has a Rheostat Dial on the top of the transmitter (0 is the lowest and 127 is the highest). Remember that you will need to adjust the setting (upward or downward) depending on your dog's temperament and threshold for stimulation. Always start at the lowest level and work your way up. The appropriate level can be found when the dog responds to the stimulation with a mild reaction. Also, as the dog's attitude changes, especially during times of increased excitement or distraction, you may need to adjust the intensity level.

Note: The stimulation intensity can be adjusted even when the stimulation is in use.

5. Maximizing the Distance

The T&B DUAL has a 1.5-mile range. Depending on the way you use your transmitter, the transmitter range may vary.

To get the greatest range, hold the transmitter away from your body and avoid touching the antenna. Keep your unit properly charged for maximum signal strength.

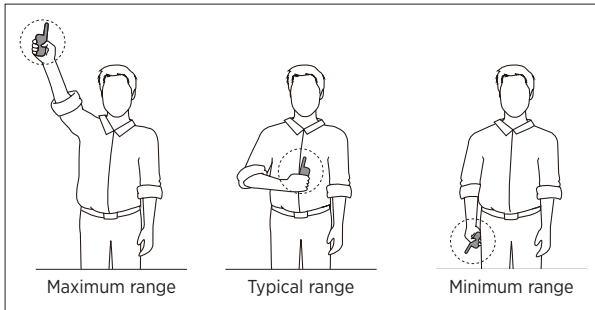

6. LED Indicator

The LED indicator flashes every 5 seconds when the receiver is on and ready for use. The LED indicator will blink on both the transmitter and the receiver when the transmitter buttons are pressed.

The LED indicator color indicates the battery life level.

Green = Full charge

Amber = Medium charge

Red = Needs charge

If the unit is used while the LED indicator is red, it may shut down automatically.

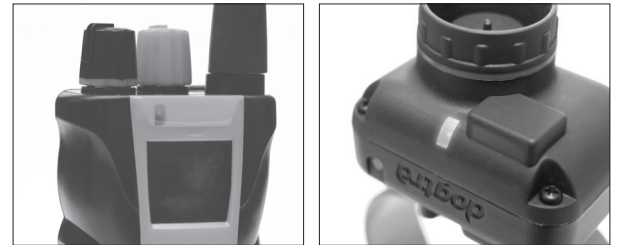

Receiver Indicator Light

When the Constant button on the transmitter is pushed, the collar indicator light will glow steadily (either green, amber, or red based on the remaining battery life), as long as you hold the button down, for up to 12 seconds. When the Nick button is pushed, the light comes on for a fraction of a second.

7. Charging the Battery

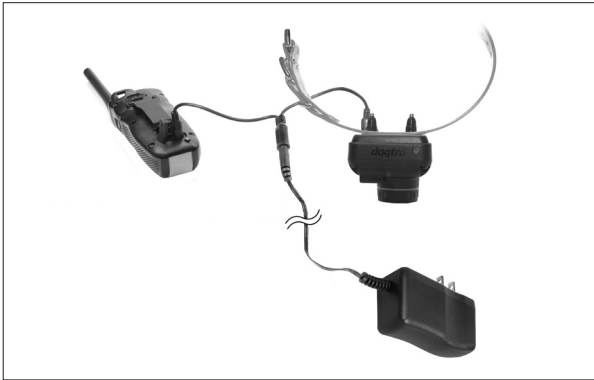

1. Charge the unit before using the unit for the first time.
2. Do not charge the batteries near any flammable substances.
3. Fully charge the batteries if the unit is to be stored without use for a period of 3 months or more.

Recharge the Unit If:

1. The LED indicator light on the receiver/collar is emitting a red color.
2. If the 3 bar indicator on the transmitter LCD shows just 1 bar.
3. The indicator light on the transmitter or receiver will not come on.
4. The indicator light on the transmitter or receiver comes on momentarily, but will not stay on when the Constant button is pushed.

Battery Charging Procedure

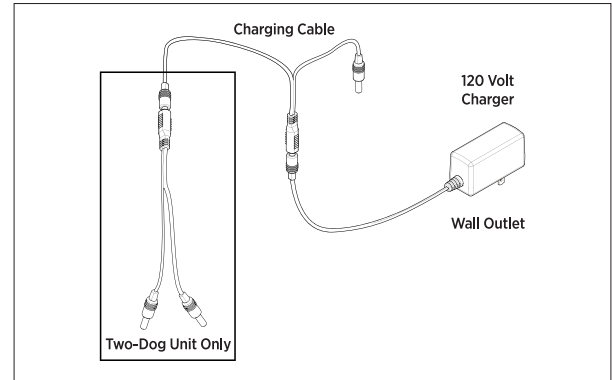

The T&B DUAL uses lithium-polymer batteries.

The battery charger and charging cables allow you to charge both the transmitter and receiver at the same time. The battery charger is designed for a 120 volt wall outlet.

Note 1: Only use Dogtra-approved lithium polymer batteries and chargers for your Dogtra e-collar. This will prevent any damage that can be incurred from attempting to use a different charger.

Note 2: The unit has a partial charge when it leaves the Dogtra facility. Upon receipt of the collar, be sure to give it a full 2-hour initial charge before the first use. When a charger is not in use, disconnect it from the power source.

1. Attach the charging cables to both the transmitter and receiver, as shown above.
2. Plug the charger into a 120 volt wall outlet or, if using

the auto charger, plug into a cigarette lighter only for lithium polymer batteries (use a 230 volt European charger for Europe). All indicator lights should glow red when properly plugged in and the unit will automatically shut off during the charging process. You will need to turn the unit on again before use once the unit is fully charged and unplugged from the battery cable.

3. The lithium polymer battery is fully charged within 2 hours. The lights will stay red during the charging process. The red light will turn green once the unit is fully charged.
4. After charging, cover the battery charging receptacles with the rubber plugs on the transmitter and receiver.

8. Handheld Transmitter OLED

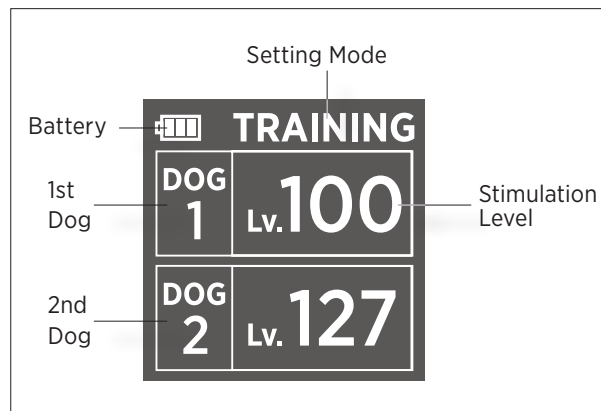

The OLED screen indicates the stimulation level on the screen ranging from (0-127). The battery life indicator shows: 3 bars = full charge, 2 bars = medium charge, and 1 bar = needs charge.

The battery life indicator only shows the remaining charge of your transmitter. To find the remaining charge for your receiver/collar, observe the LED indicator light on the receiver/collar.

Care for OLED Transmitters in Cold Temperature

In cold temperatures (10°F or below), the Organic Light-Emitting Diode(OLED) on your transmitter may be dim or slow to respond. Wait until the display becomes visible before selecting any training level. Even though the OLED screen might be dim or slow to respond when you push the Nick or Constant button, the transmitter will still function properly. In the occurrence of extremely cold weather, the OLED screen might take a moment to respond causing the intensity level to freeze at that current level. In this situation, if you turn the Rheostat Dial, the level on the screen may not change but the actual intensity from the receiver/collar will change in agreement with the dial.

In this situation, it is ideal to either wait until your transmitter is back to working order before emitting a correction, or while holding the Constant button down slowly turn the Rheostat Dial while watching your dog's reaction. Do not turn the Rheostat Dial rapidly, because the receiver/collar will emit a static correction based on the level of the Rheostat Dial, which might not be correctly reflected on the OLED screen.

Attention!

When using the unit in cold temperatures, it is recommended that the transmitter is placed under your jacket next to your body. The warmth of your body will greatly improve the battery life and usage.

9. Attaching the Belt Clip

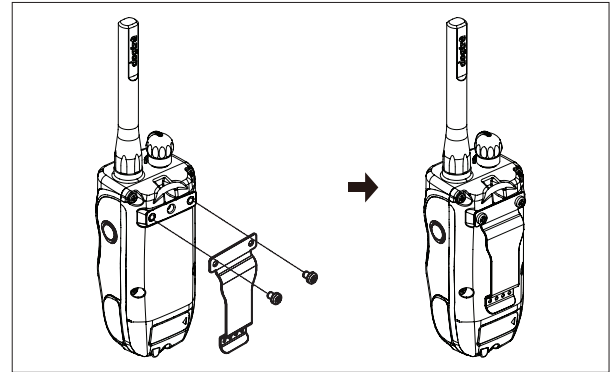

Follow the instructions below to attach the included belt clip to the transmitter.

1. Align the belt clip to the grooves on the back of the transmitter.
2. With a firm grip, screw on the belt clip's Phillips head screws with a screwdriver.

Caution!

Tighten until firmly in place. Be careful not to over tighten.

10. Using the Test Light



1. To turn on the receiver/collar, place the red dot on the back of the transmitter to the red dot on the receiver/collar. Hold the two red dots together for a moment until the LED light on the receiver/collar comes on. The indicator light will come on for a moment then blink once every 5 seconds, showing that the collar is ready to use (the receiver needs to be charged if the indicator light is red). The receiver/collar will emit a melody when turned on.
2. Turn the transmitter on by pressing the on/off button on the right side of the transmitter until the OLED screen illuminates. The LED will blink every 5 seconds and the OLED screen will show the remaining battery life (the transmitter needs to be charged if there is only 1 bar showing on the battery icon for the OLED transmitter screen).
3. Place the test light, included in the package contents, on the contact points as shown in the diagram.

4. Watch the test light as you push the Nick button on the transmitter. It should light up for just a moment. The higher the intensity, the brighter the test light will be.
5. Watch the test light as you push the Constant button on the transmitter. It should light up as long as the button is pressed. However, as a safety feature, the receiver/collar will automatically stop the stimulation if the Constant button is pressed for 12 seconds or longer.
6. Turn the Rheostat Dial on the transmitter clockwise and then counterclockwise. The test light should glow brighter with higher levels of stimulation and dimmer with lower levels. When you change the intensity dial, the number on the OLED screen will change as well.

Note: The test light may not be visible if the intensity level is set below level ten.

7. To make sure that your beeper is working properly, press the Locate button once with the horn portion facing away from you (or place your hand over the horn). The sound may be extremely loud and may cause discomfort to your ears. If you do hear an audible beeper sound, your Locate button is in working order.
8. Press the Beeper Mode button once; you should hear 2 rapid beeps. This will put you into the Run/Point mode. Keep the receiver/collar steady to mimic your dog at a standstill point. Wait for a moment until you hear a double beep every 2 seconds. You may proceed to the next step if the double beep occurs.

9. Press the Beeper Mode button a second time; you should hear 1 rapid beep. This will put you into the Point-Only mode. Once again, keep your receiver/collar steady and wait for a moment until the collar emits a double beep every 2 seconds. If it is audible, move onto the next step.
10. Press the Beeper Mode button a third time; you should hear 3 rapid beeps. This mode will turn off your beeper and remain silent.

Note 1: The pitch that the beeper will emit will vary depending on your setting with the (high/low) Pitch Setting button.

Note 2: In the Run/Point or Point-Only mode, it is still possible to use electrical stimulation.

11. Code Setting Guide

Code setting for 1-dog use

1. Turn the transmitter on by pressing the on/off button located on the side of the transmitter and set the Rheostat Dial to 0.
2. With the receiver/collar turned off, place the red dot on the back of the transmitter to the red dot of the receiver/collar you would like to code. Hold the two red dots together for about 5 seconds until the green LED blinks rapidly on the receiver/collar.
3. While the green LED is rapidly blinking on the receiver/collar, press the Nick/Constant and Pager buttons on the front (for 1st dog) of the transmitter simultaneously. The LED indicator light on the receiver/collar will blink every 5 seconds when the coding is complete.

Code setting for 2-dog use

4. To code the Dogtra T&B DUAL for 2-dog use, repeat steps 1 and 2 above. While the green LED is rapidly blinking on the receiver/collar, press the Nick/Constant and Pager buttons on the side (for 2nd dog) of the transmitter simultaneously. The LED indicator light on the receiver/collar will blink every 5 seconds when the coding is complete.
5. When a button is pressed on your coded handheld transmitter, an LED indicator light will blink on the corresponding receiver/collar.
6. With the 2nd receiver/collar coded to the T&B DUAL, the orange buttons will operate your existing receiver/collar, and the black buttons will operate the newly coded receiver/collar.

GENERAL TRAINING TIPS

Getting Started With Your T&B DUAL

Your dog must know some basic obedience commands before beginning training with the T&B DUAL. A dog learns by first being shown a command, followed by lots of repetition over an extended period. As the dog becomes proficient at these commands, the trainer can introduce distractions and different locations to strengthen them.

Obedience Training on the Leash

Your dog must fully understand the obedience commands (sit, stay, here, heel, and kennel) before using the e-collar for reinforcement of these commands. A leash attached to a standard collar is used to "teach" the dog the basic obedience commands (here, heel, sit, and stay). A tug on the leash/collar is used to reinforce the command. When the dog complies with the command, use positive reinforcement/praise. Once the dog understands these commands, the e-collar can be used to reinforce them.

Beginning E-Collar Training

When you feel your dog understands the obedience commands on the leash we can now start with the e-collar training. With the dog on the leash and wearing the e-collar, continue with your obedience drills. Apply light stimulation (Nick or Constant) when a command is given; the stimulation can be removed as the dog complies. Through repetition, the dog learns to perform the command.

The final step is the avoidance phase in which the dog learns that he can avoid the stimulation altogether by performing your commands. When these training procedures are complete, the e-collar is used as a reminder when the dog does not comply with your commands at home or in the field. Keep your initial training sessions short and positive as dogs have a short attention span.

How Much Stimulation to Use

Always start with low levels of stimulation and work your way up depending on the disposition of your dog and the given situation. By using the correct amount of stimulation to get your point across, you will have a more controllable environment and a dog that is under less stress. Animals (and humans) perform better in a less stressful environment.

For more training information, please visit our website at www.dogtra.com.

MAINTENANCE

Basic Maintenance

Be sure the rubber charging cap is securely in place when the collar is in use. After each training session, carefully inspect the unit for any missing parts or damage to the casing. Damaged or broken casing may affect the waterproof guarantee on the unit. After confirming that there is no damage to the casing, rinse the receiver/collar and clean out any dirt or debris.

Storage Maintenance

The T&B DUAL should be fully charged before storing for extended periods. While in storage, the unit should be given a full charge once a month, and before the first use. Store the units in room temperature. Do not keep the units exposed to extreme climates.

Troubleshooting

If the unit is malfunctioning, please refer to the “Troubleshooting Guide” before sending it to Dogtra for service. If you have any questions or concerns, you may email them to info@dogtra.com, or call customer service at 1-888-811-9111.

TROUBLESHOOTING GUIDE

1. My dog is not reacting to the collar.

- Make sure the receiver is turned on: Place the two red dots together to turn on the receiver and push the black button on the transmitter until it illuminates to turn on the transmitter.
- Be sure the collar strap is tight enough so both contact points are touching the dog's skin.
- The contact points may be too short for the dog. To place an order for longer contact points that are more appropriate for your dog, please call (888) 811- 9111. If you are already using the longest contact points available, you might need to trim down the hair on the dog's neck so both contact points are touching the dog's skin.
- The intensity level may be too low for your dog. Keep increasing the stimulation until the dog responds, usually with neck movement, head shaking, looking over its shoulder, etc. (response may be very subtle).

2. The test light comes on, but I do not feel any stimulation.

- Your tolerance may be higher than your dogs. We recommend placing both contact points on your inner wrist, where the sensitivity is higher, in order to test the unit.
- The battery may be low, so check the LED light for battery life.
- If you have a full charge and you have done all of the above, your unit may need to be serviced. Please contact customer service at info@dogtra.com or (888) 811-9111.

3. The transmitter has no range or stimulation is less when the dog is farther away.

- The antenna(s) may be damaged. To order parts, please contact customer service at (888) 811- 9111 or go to www.dogtra.com.
- The range indicated on the unit's box is for flat terrain. Heavy brush, trees, hills, or moisture will affect the range of your unit. For best range, hold the transmitter vertically above your head, and/or try moving to higher ground.
- Any electrical conductors will affect the range, such as cars, chain-link dog runs, metal building, and radio towers. For best results, operate away from these structures.

4. My unit is not holding a charge.

- The batteries might not be charged properly, or the charger, splitter, and the charging port needs to be looked at. If you suspect your charger/splitter is not functioning properly please contact customer service at info@dogtra.com or (888) 811-9111. You can send in your charging units to have us inspect them.
- The charging pin may be damaged. Inside the charging port, there is a metal pin that should be standing straight up and stiff. If the pin is wobbling, broken, or missing, you will need to send the unit in to the Repair Department. The charging port must be clean prior to charging; clean the dirt out with a cotton swab and some rubbing alcohol. If the dog is in salt-water, be sure to rinse the receiver and charging port with clean water.

- For Dogtra units over two years old from the purchase date, the batteries may need to be replaced. You can replace them yourself by contacting Dogtra. But, damages incurred to the unit due to improper battery installation are not covered under any warranty and any other unauthorized servicing or tampering with the unit voids your limited lifetime warranty. This will be up to the user's discretion. If you are still having problems after replacing the batteries, Dogtra strongly recommends sending the unit in for inspection.

DOGTRA EXTENDED PRODUCT WARRANTY

EXTENDED LIMITED WARRANTY

For Certain Dogtra Products Purchased from Dogtra Authorized Dealers

1+1 Year Extended Warranty

Except as otherwise provided, Dogtra warrants to the original retail purchaser ("You") that your Dogtra product shall be free of defects in materials and workmanship for a period of one (1) year from the date of purchase ("Original Warranty"). As a special promotion, Dogtra further warrants that your Dogtra product shall be free of defects in materials and workmanship for an additional one (1) year from the date that your original warranty expires ("Extended Warranty"). The Original and Extended Warranties cover the cost of repair (parts and labor) or replacement (if repair is not feasible) of a defective Dogtra product during said warranty periods. For such repaired or replaced products, the remaining portion of the warranty periods, or ninety (90) days, whichever is longer, shall apply. Dogtra, at its sole discretion, shall determine whether to repair or replace a product covered by the Original Warranty or Extended Warranty.

Warranty Conditions

The Original and Extended Warranties are not transferrable and apply to your Dogtra product only if:

- (1) You are the original retail purchaser of the product,
- (2) You bought the product from a Dogtra Authorized Dealer, and
- (3) You present a receipt or other proof of purchase showing a valid purchase date, the name and address of the Dogtra Authorized Dealer, and the purchased product identified by model and/or serial number.

Warranty Exclusions

The Original and Extended Warranties do not cover damage, loss, or deterioration to your Dogtra product caused: by misuse, neglect, abuse, or other improper handling of the product; by failure to follow use or care instructions; by use of the product for other than its intended purpose; by accident or natural forces such as fire or flooding; or by normal wear and tear such as scratches to the product surface.

The Original and Extended Warranties also do not cover Dogtra products that: are purchased from non-authorized dealers; are purchased outside of the United States or Canada; have been damaged during shipment (even if Dogtra paid or arranged for shipping); have been modified or tampered with in any manner; are opened or repaired by anyone other than Dogtra; or have serial numbers that have been altered or defaced.

Sole Warranties

The Original and Extended Warranties are the only warranties offered by Dogtra for your Dogtra product during said warranty periods. Other than the Original and Extended Warranties, Dogtra makes no other representations or warranties whatsoever regarding its products, whether oral or in any product manual, on any packaging, on any website, or in any other written material. No dealer of Dogtra products, nor any employee or agent of Dogtra, is authorized to make any additions, changes, or extensions to the Original Warranty or Extended Warranty. Dogtra, at its sole discretion and at any time, reserves the right to modify the Original and/or Extended Warranties.

**DISCLAIMER OF OTHER WARRANTIES
THE FOREGOING ORIGINAL AND EXTENDED WARRANTIES ARE PROVIDED IN LIEU OF ALL OTHER WARRANTIES, WHETHER EXPRESS OR IMPLIED. DOGTRA DISCLAIMS ANY IMPLIED WARRANTIES INCLUDING, BUT NOT LIMITED TO, THE IMPLIED WARRANTIES OF MERCHANTABILITY AND FITNESS FOR A PARTICULAR PURPOSE.**

Limitation of Remedies

Dogtra's liability is limited to the cost of repair or replacement of the Dogtra product under the Original Warranty or Extended Warranty. Any claim or action to enforce the Original and/or Extended Warranties must be commenced within thirty (30) days of such warranty's expiration for your product. Dogtra will not be liable for any indirect, incidental, special, consequential, or similar damages based on breach of warranty, breach of contract, negligence, strict tort, or any other legal theory related to Dogtra and its products. Damages that Dogtra will not be responsible for include, but are not limited to: loss of income or profits; loss of revenue or savings; loss of use of the product or associated products; cost of any substitute products or services; inconvenience, downtime, or any other time; loss of goodwill; claims of third parties including customers; and damage to property.

Legal Rights May Vary By State or Jurisdiction

The Original and Extended Warranties give You specific legal rights, and You may also have other rights which vary by state or jurisdiction. Some states or jurisdictions do not allow certain limitations of implied warranties or of incidental or consequential damages or other remedies, so certain of the foregoing limitations may not apply to You.

If any portion of the Original Warranty or Extended Warranty is held by a court to be invalid or unenforceable, the remaining portions of such warranties shall remain in full force and effect and shall in no way be affected or invalidated, and the invalid or unenforceable portion shall be modified so as to most nearly achieve the intent of the Original Warranty or Extended Warranty.

Product Registration

Dogtra recommends that customers register their products as soon as possible after purchase. Product registration will facilitate any future warranty service. You may also receive useful information and updates about your existing and future Dogtra products. To register your product, visit www.dogtra.com/product-registration. If your product is not registered with Dogtra, You will be required to provide a receipt or other proof purchase (as provided above) to qualify for warranty service.

How to Obtain Warranty Service

Should your Dogtra product require warranty service, please contact Customer Service by phone or email for a warranty evaluation (see below for contact information). Upon approval of your warranty work, Dogtra will repair or replace (at Dogtra's election) your product without charge for labor or parts. You are responsible for shipping, including cost, of your product to Dogtra for warranty service. Dogtra will handle shipping, including cost, of the repaired or replaced product back to customers in the USA. Dogtra will not be responsible for shipping, including cost and/or applicable taxes or fees, for products sent outside the USA. Such costs, taxes, or fees will be borne by the customer.

Dogtra Customer Service

22912 Lockness Avenue, Torrance, CA 90501

(888) 811-9111

repair@dogtra.com

Mon - Fri, 8:00 AM to 4:30 PM (PST)

© 2019 Dogtra. All rights reserved.

